

OPERATOR'S MANUAL

INCLUDING: OPERATION, INSTALLATION & MAINTENANCE

670088-XXX

670089-XXX

RELEASED: 10-14-08
REVISED: 5-28-09
(REV. 02)

1-1/2" DIAPHRAGM PUMP 1:1 RATIO, NON-METALLIC



**READ THIS MANUAL CAREFULLY BEFORE INSTALLING,
OPERATING OR SERVICING THIS EQUIPMENT.**

It is the responsibility of the employer to place this information in the hands of the operator. Keep for future reference.

GENERAL DESCRIPTION

The 670088-XXX and 670089-XXX special 1-1/2" diaphragm pumps are similar to models PD15P-XXX-XXX diaphragm pumps. These pumps feature inlet and outlet manifolds with 1-1/2" A.N.S.I. / DIN fluid connections.

A PD15P-XXX-XXX operator's manual (part number 97999-1055) is to be used for General Information, Installation, Operation and Maintenance. Follow the standard parts list with the exception of the items listed below.

MODEL CHART

Model	Standard Model	Fluid Section Repair Kit	Air Section Repair Kit
670088-PAA	PD15P-YP5-PAA	637391-AA	637389
670089-KAA	PD15P-YKS-KAA	637391-AA	637389
670089-KTT	PD15P-YKS-KTT	637391-TT	637389

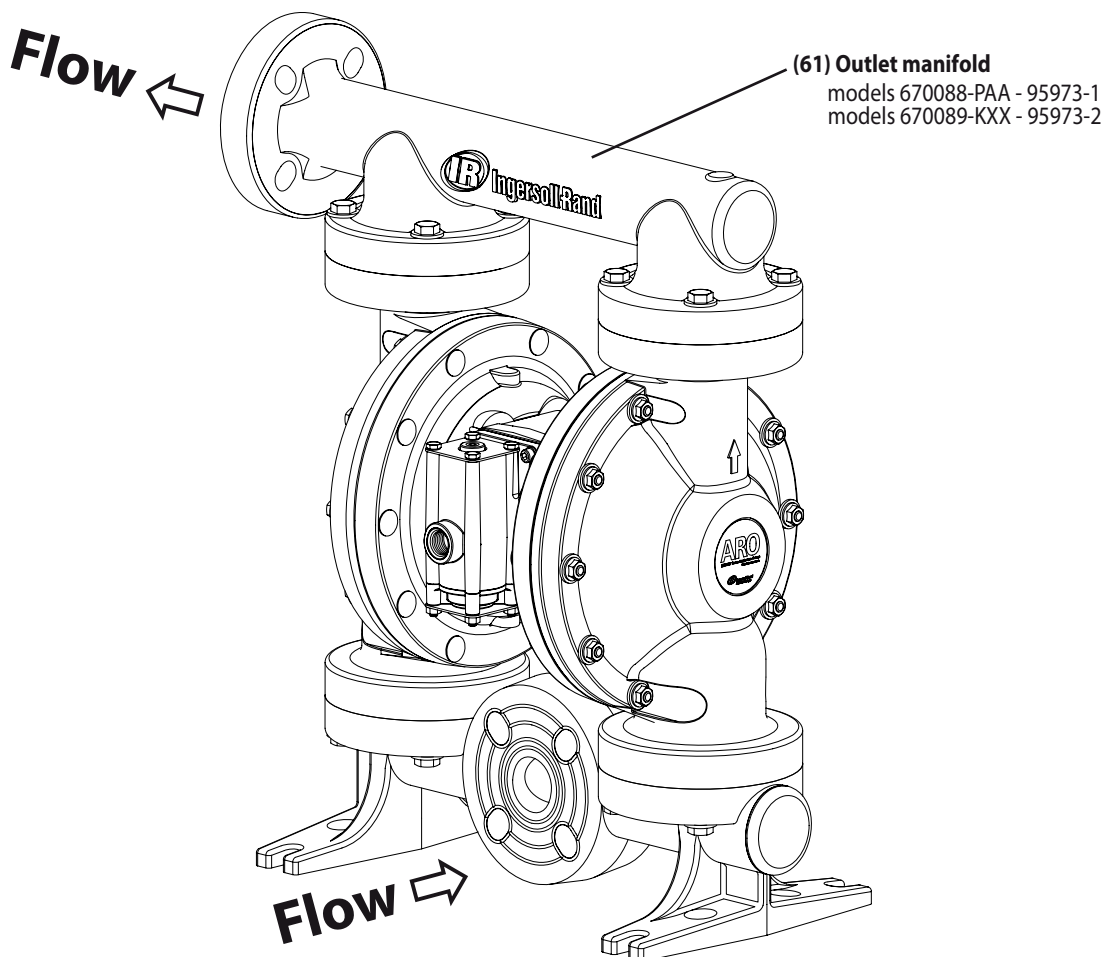

PN 97999-1148

INGERSOLL RAND COMPANY LTD
P.O. BOX 151 • ONE ARO CENTER • BRYAN, OHIO 43506-0151

① (800) 276-4658 • FAX (800) 266-7016

© 2009

CCN 15323520

ARO

IR Ingersoll Rand
Industrial Technologies